

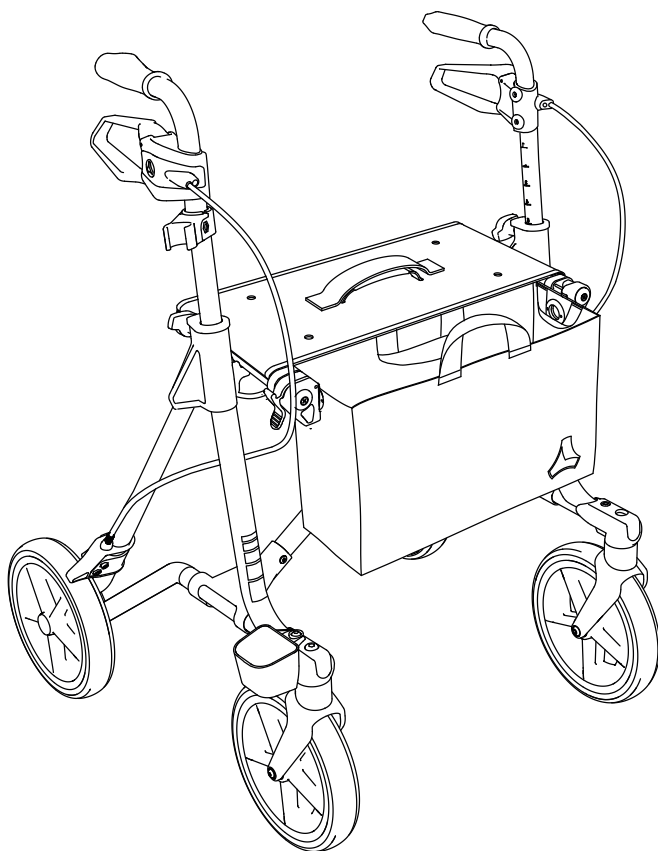

**TAİMA** **VENTUM**

Premium rollator  
User manual version 1.0 EN



### Record of product identification data:

We recommend making a note of your product identification data below so that you have these to hand if you have any queries about your product. All the data can be found on the product label. (see section "Product labelling"\*)

<b>TYP</b> Type / model:	
<b>REF</b> Item No. / REF:	
<b>SN</b> Serial number	
 Date of manufacture:	
Other information / notes:	

\* The identification data or the type plate may deviate in the case of custom-made products.

## Thank you for choosing the TAI<sub>A</sub>MA VENTUM rollator by DIETZ.

This product is a medical aid. In order to use it properly and avoid possible risks due to improper use, you must familiarise yourself thoroughly with its operation.

Read this user manual carefully before you begin using your product. It contains important instructions that will enable you to fully take advantage of the technical benefits. In addition, you will receive information that will aid with maintaining operational safety and the preservation of your investment in your product.

If you have any questions or require additional information, please contact the specialist retailer which supplied the product to you.

You will always find the latest information about

the user manual as well as further information and documents about your product on our website. For information or queries concerning product safety and on recalls, please contact DIETZ GmbH in writing or by telephone. You will find our contact information at the end of this user manual.

To improve the readability of this document, the simultaneous use of the masculine, feminine and diverse (m/f/d) forms of language is avoided in the following and gender-neutral language has been used. All references to persons shall apply equally to all genders.



### NOTE

A large-print version of the user manual is available for visually impaired persons at **shop.dietz-group.de** in PDF format.



<b>1 Important information</b>		<b>4 Using the product</b>	
1.1 General information . . . . .	6	4.1 Walking with your rollator . . . . .	12
1.2 Intended purpose . . . . .	6	4.2 Using the curb climber. . . . .	13
1.3 Indications . . . . .	6	4.3 Applying the service brakes . . . . .	14
1.4 Contraindications . . . . .	6	4.4 Applying the parking brakes . . . . .	14
1.5 Signs and symbols. . . . .	7	4.5 Brake adjustment . . . . .	15
<b>2 Product description</b>		4.6 Folding and unfolding your rollator . . . . .	15
2.1 Scope of delivery . . . . .	8	4.7 Carrying your rollator . . . . .	17
2.2 Options. . . . .	8	4.8 Transport. . . . .	17
2.3 Reference diagram . . . . .	9	4.9 Standard bag (fitted as standard). . . . .	17
<b>3 Preparing the product for use</b>		4.10 Premium bag (optional). . . . .	19
3.1 Assembly instructions . . . . .	10	4.11 Back strap (optional). . . . .	20
3.2 Setting up / unfolding your rollator . . . . .	10	4.12 Cane holder (fitted as standard) . . . . .	21
3.3 Adjusting the grip height . . . . .	11	4.13 Tray (optional). . . . .	22
		4.14 One-hand brake system (optional) . . . . .	23
		4.15 Extended push handles (optional) . . . . .	23
		4.16 Umbrella (optional) . . . . .	24
		4.17 Accessories and add-ons / conversions from external suppliers . . . . .	25

## 5 Technical specifications

5.1 Dimensions and technical information . . .	26
5.2 Product tests . . . . .	26
5.3 Further information . . . . .	27
5.4 Materials / colours . . . . .	27
5.5 Product labelling . . . . .	28

## 6 Safety instructions

6.1 Safety instructions . . . . .	29
-----------------------------------	----

## 7 Care and maintenance

7.1 Servicing/maintenance . . . . .	31
7.2 Maintenance schedule . . . . .	32
7.3 Troubleshooting . . . . .	34
7.4 Cleaning . . . . .	36
7.5 Disinfection . . . . .	36
7.6 Disposal . . . . .	36
7.7 Passing on the product for reuse . . . . .	36
7.8 Storage . . . . .	37

## 8 Manufacturer's declarations

8.1 Warranty . . . . .	38
8.2 Service life . . . . .	38
8.3 Liability . . . . .	38

## 1.1 GENERAL INFORMATION

---

This user manual is included in the scope of delivery and forms an integral part of the product. The user should keep this manual to hand at all times and it must remain with the product if passed on to a third party for reuse. To check

that you are in possession of the latest version of the user manual, please contact DIETZ GmbH. Read the user manual before commissioning and using the product.

## 1.2 INTENDED PURPOSE

---

The TAIiMA VENTUM rollator has been specially designed for persons with limited mobility (max. body weight, incl. load 150 kg) as a walking aid and temporary seat. The rollator can also be used as a means of transport for e.g. shopping up to a load of 5 kg by means of a bag that can be attached in front of the seat. The product is designed for indoor and outdoor use and can be used on flat, solid surfaces. It is used for both private purposes and in in-pa-

tient facilities, such as retirement and nursing homes, hospitals as well as rehabilitation and therapy centres. The product is not intended to serve as permanent seating and must not be used for this purpose.

The intended purpose may differ for products which were manufactured as custom models and which have been labelled as such. In this case, please refer to the documentation supplied with the product.

## 1.3 INDICATIONS

---

This product is recommended in the case of:

- ▼ Impaired mobility due to a restriction of the active or passive musculoskeletal system
- ▼ Coordination difficulties when walking
- ▼ Reduced load-bearing capacity

## 1.4 CONTRAINDICATIONS

---

The product must not be used in the case of:

- ▼ Perception disorders
- ▼ Severe balance disorders
- ▼ A user weight exceeding 150 kg
- ▼ Inability to stand freely
- ▼ Nor must it be used by children or anyone who is less than 146 cm tall and/or who weighs less than 40 kg (BMI <17)

## 1.5 SIGNS AND SYMBOLS

---

These symbols indicate passages of text that are helpful for using and operating the product in everyday life.



---

### WARNING

It is mandatory to observe and comply with warnings. They draw your attention to the fact that failure to comply with them may result in injury and/or damage to the product or the environment. \_\_\_\_\_



---

### NOTE

Tips and advice which make using the various functions easier. \_\_\_\_\_

## 2.1 SCOPE OF DELIVERY

---

The product is assembled at the factory and delivered inside a cardboard box. On receipt of the goods, please immediately check to make sure that the contents are complete and undamaged. If the contents are noticeably damaged, inform the supplier immediately.

The contents consist of:

- ▼ 1 TAIiMA VENTUM rollator
- ▼ 1 user manual
- ▼ 1 cane holder (mounted on the right)
- ▼ Components that are not fitted to the product, e.g. standard bag



### WARNING

**Risk of poisoning:** When burnt, packaging films can release toxic gases.

**Risk of suffocation:** Keep the plastic bags out of the reach of children. \_\_\_\_\_



### NOTE

The equipment features that are described as well as the scope of delivery may differ from country to country and from market to market and are dependent on the individual indication and clinical picture. \_\_\_\_\_

## 2.2 OPTIONS

---

- ▼ Premium bag
- ▼ Back strap
- ▼ Extended push handles
- ▼ One-hand brake system, left/right
- ▼ Umbrella
- ▼ Cover
- ▼ Tray



## 2.3 REFERENCE DIAGRAM

1. Seat cover
2. Folding lock hooks
3. Brake lever
4. Cane holder (upper part)
5. Locking screw for height adjustment
6. Lateral reflectors
7. Bag suspension, magnetic
8. Front reflector stickers
9. Rear reflectors
10. Brake
11. Rear wheel
12. Cane holder (lower part)
13. Ergonomic handgrips
14. Bowden cable
15. Push handle, height adjustable with step indicator
16. Carrying strap
17. Pull strap (grey), for releasing the folding lock
18. Standard bag
19. Front wheel (steering wheel) w/o fig. Curb climber, both sides



### NOTE

This image is designed to help you clearly identify the individual components of your rollator. Therefore, please always refer to it when reading the user manual.

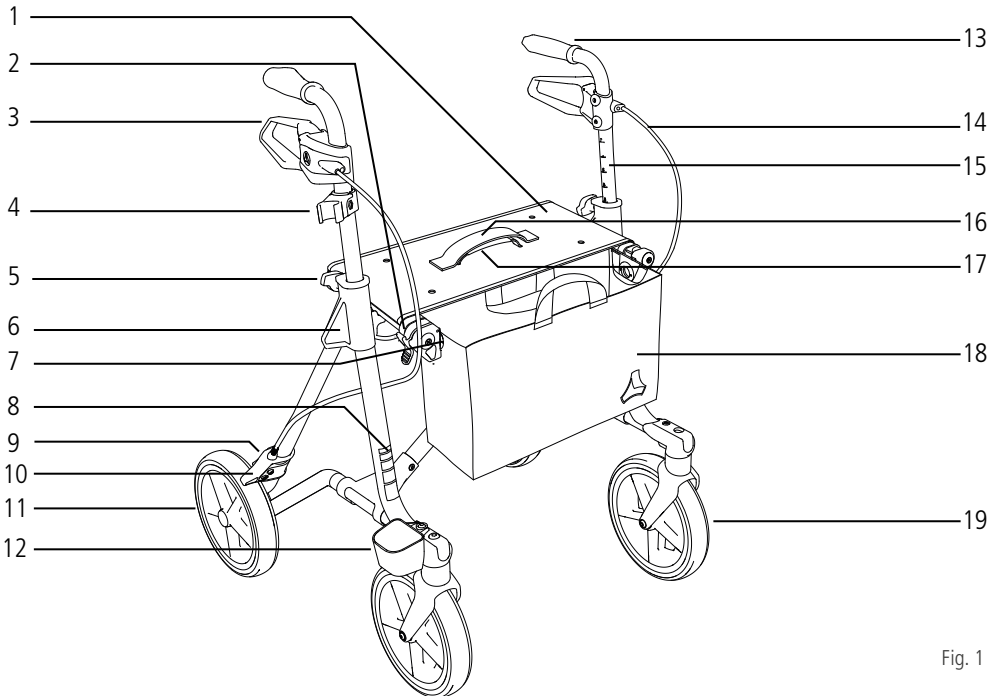

Fig. 1

### 3.1 ASSEMBLY INSTRUCTIONS

The TAIiMA VENTUM rollator is fully assembled at the factory. The following sections describe how to set up the rollator, adjust it to suit your requirements and enable you to use it comfortably. The functional check is to be performed by the specialist retailer. The specialist retailer's technician will adjust the product as appropriate for the respective user.

### 3.2 SETTING UP / UNFOLDING YOUR ROLLATOR

1. Position the rollator in front of you with the handles pointing towards you.
2. If necessary, the folding lock hook (1, Fig. 2) must be loosened (see section "Folding and unfolding your rollator").
3. Push the side tubes of the seat apart and down (2, Fig. 2) until the rollator has unfolded completely and the seat cover is tensioned.
4. Now the folding lock (3, Fig. 2) can be heard to engage in the pin (4, Fig. 2) provided for this purpose underneath the seat cover and the rollator is correctly unfolded.



#### WARNING

**Safety hazard!** Only use the rollator if the folding lock is correctly engaged.

**Risk of trapping!** Take care not to trap your hands, fingers or clothing when operating the folding lock and when unfolding/folding the rollator!

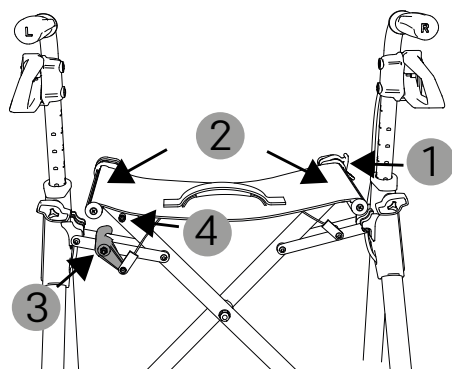

Fig. 2

### 3.3 ADJUSTING THE GRIP HEIGHT

1. Loosen the locking screws of both push handles by turning them anticlockwise two turns (1, Fig. 3). Do not loosen the locking screws fully.
2. The push handles can now be adjusted in height (2, Fig. 3). In doing so, they position themselves automatically at the markings. A clicking sound can be heard when it clicks into place.
3. When you adjust the height, orientate yourself on the step indicator so that both push handles are set at the same height.
4. When the correct height of the push handles has been found, tighten the locking screws (1, Fig. 3) again (clockwise).

Familiarise yourself thoroughly with your product before using it for the first time so that you feel safe and confident handling the rollator. Seek the support of an accompanying person.

Check that the rollator has been correctly assembled before using it:

- ▼ Are all attached parts firmly fixed in place?
- ▼ Have all screws been firmly tightened?
- ▼ Do the brakes work?
- ▼ Does the rollator rest on all four wheels?
- ▼ Do the wheels turn smoothly when pushed?
- ▼ Is the rollator fully unfolded and the folding lock engaged?

- ▼ Is the rollator bag hanging correctly in the magnetic bag suspensions (see also section "Standard bag")?



#### WARNING

**Safety hazard!** Never fix the push handles between the locking positions of the step indicator, instead fix them precisely on one of the pre-set positions! This is the only way of ensuring a secure fix!

**Safety hazard!** Both locking screws must be firmly tightened prior to using the rollator. \_\_\_\_\_



#### NOTE

To use TAIiMA VENTUM correctly, it must be adjusted to your individual size. This adjustment should be performed by a trained person. \_\_\_\_\_

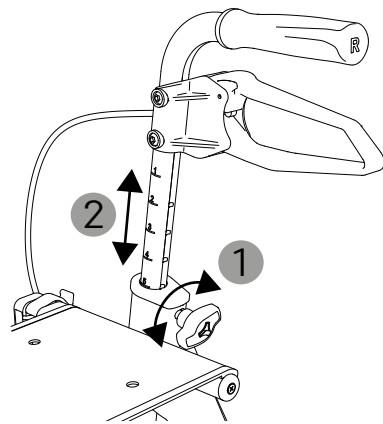

Fig. 3

## 4.1 WALKING WITH YOUR ROLLATOR

---

You will find information here on how to walk safely with your TAIiMA VENTUM:

1. Position yourself behind the rollator and grab the push handles with both hands.
2. As soon as you are safely stood up, you can loosen both parking brakes (see also section "Applying the parking brakes").
3. You can now start walking.
4. Do not push the rollator too far in front of you. In order to give good support, the rollator should be kept close to your body.
5. Control your speed if necessary by gently applying both brake levers evenly (see also section "Applying the service brakes").
6. Walk upright and look forwards to be able to identify and avoid any upcoming obstacles early.
7. Use the brake (pull the brake lever upwards) on sloping paths and do not use paths that are excessively steep.
8. Do not walk backwards with your rollator.



### WARNING

**Important information!** The points described here are important for your safety! \_\_\_\_\_

## 4.2 USING THE CURB CLIMBER

It is easier to overcome curbs and other obstacles by tipping the rollator. The TAIiMA VENTUM has a curb climber mounted on both sides for this purpose.

1. Ensure that you have a firm footing.
2. Gently press the curb climber with your toe (fig. 4). This slightly lifts the front wheels of the rollator.
3. Push the rollator onto the obstacle, let the front wheels sink back down and take your foot off the curb climber.



### WARNING

**Risk of tipping!** Always be aware that pressing the curb climber may impair your balance. Only use it if you have a secure footing and the step is not too high. \_\_\_\_\_

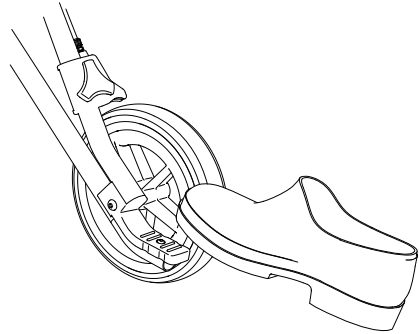

Fig. 4

### 4.3 APPLYING THE SERVICE BRAKES

This is where you learn how to use the brakes while walking (service brakes). This may be necessary if you are walking down a slight slope, for example. In doing so, the wheels are braked gently and the rollator does not roll away from you.

1. To brake the rollator while walking in a controlled manner, pull both brake levers evenly and gently upwards (Fig. 5)
2. The wheels will run freely again as soon as you let the brakes return to their neutral position.



#### WARNING

**Safety hazard!** Always use the brakes carefully when walking. Applying the brakes abruptly could result in you stumbling or losing your balance.

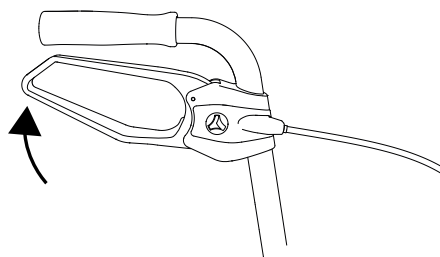

Fig. 5

### 4.4 APPLYING THE PARKING BRAKES

Proceed as follows if you want to "park" the rollator:

1. To block the brakes (parking brakes), press the brake levers downwards (Fig 6). You will be able to tell when they noticeably snap into place.
2. To release the brakes, press the levers back upwards.



#### WARNING

**Sources of fire!** Please keep the rollator away from sources of fire to prevent ignition.

**Safety hazard!** Always apply the parking brakes when stopping for extended periods of time or when the rollator is parked unattended.

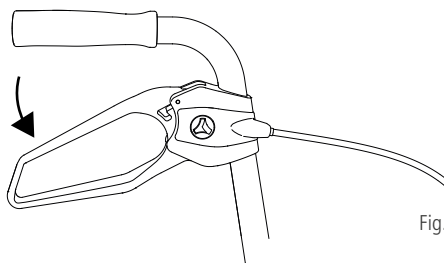

Fig. 6



#### WARNING

**Risk of trapping!** Ensure that when applying the parking brake of the rollator, your hands are positioned in a straight line on the brake to avoid any jamming.

## 4.5 BRAKE ADJUSTMENT

Check that the brakes are correctly adjusted as follows:

- ▼ The brake lever and the Bowden cables must not be loose (they must not have any "play").
- ▼ When you release the brake lever, the wheels must turn without making any scraping noises.
- ▼ If the braking effect has deteriorated, it is possible to adjust the length of the Bowden cables a little yourself. Proceed as follows in this case:

1. You will find the adjustment screws for the Bowden cables on the brakes of the rear wheels (1, Fig. 7).
2. By unscrewing (counterclockwise) you will increase the tension and reduce the distance that the brake lever travels when applied (2, Fig. 7).
3. The screw is locked using a nut. You will have to tighten the lock nut in a clockwise direction (3, Fig. 7) after adjustment to prevent the brake cables from coming loose on their own.



### WARNING

**Safety hazard!** Never fully unscrew the screw, otherwise the brake will no longer work.

**Safety hazard!** If the adjustment described here fails to improve the braking performance or if you encounter problems during the adjustment, contact your medical supply specialist! This is the only way of ensuring the safe use of the rollator.

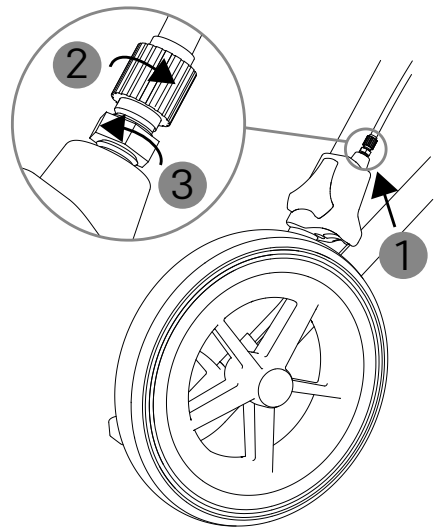

Fig. 7

## 4.6 FOLDING AND UNFOLDING YOUR ROLLATOR

It is easy to fold up the TAIIMA VENTUM by hand. It can stand freely when folded and can be stored in a way that saves space. You can fold the rollator with the standard bag

empty. If the standard bag or the premium bag is filled, they must be removed before folding (see section "Standard bag" and "Premium bag").

1. Position yourself between the push handles and reach under the grey pull strap (1, Fig. 8) to release the folding lock. The pull strap is the lower one lying flat against the seat.
2. Pull the pull strap with the seat surface upwards (2, Fig. 8).
3. As a result, the folding lock (3, Fig. 8) is released and the rollator can be folded.
4. To use the folding lock, press the two seat tubes together to the extent necessary (1, Fig. 9). Then pull the ribbed lever of the folding lock hook upwards so that it can be released from its support. Engage the folding lock hook on the counterpiece on the other side of the rollator (2, Fig. 9) by latching the hook on the pin provided for it (3, Fig. 9).
5. When unfolding the TAIMA VENTUM, release the folding lock hook from the counterpiece (4, Fig. 9) by actuating the ribbed lever.
6. The next step involves pushing both seat tubes down with your hands until the folding lock engages. This will result in a clear "clicking sound" (see also section "Setting up / unfolding the rollator").
7. Return the folding lock hook to its original position by pressing it onto the seat tube until you can hear it click into place. This prevents the hook from loosening on its own when the rollator is in use.



## WARNING

**Risk of trapping!** Take care not to trap your hands, fingers or clothing when operating the folding lock and when unfolding/folding the rollator!

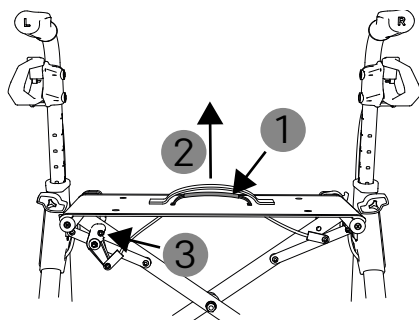

Fig. 8

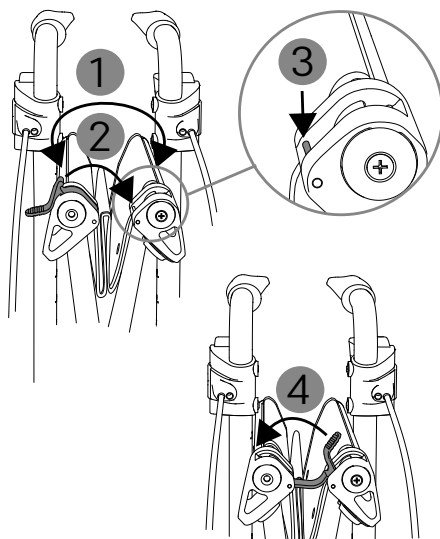

Fig. 9



## 4.7 CARRYING YOUR ROLLATOR

You can carry the rollator when it is both folded and unfolded. If you would like to carry the TAIiMA VENTUM when unfolded, you can do so with the help of the carrying strap, for example:

1. Lift the rollator using the carrying strap (upper, wide carrying strap / 1, Fig. 10) on the seat cover.
2. You can now carry it over a short distance without the folding lock coming loose.



### WARNING

**Safety hazard!** Please only lift the TAIiMA VENTUM when you are standing safely and it is not loaded heavily in order to avoid falls.

**Caution!** Only the upper carrying strap may be used for carrying. The folding lock is released by tightening the lower pull strap (grey).

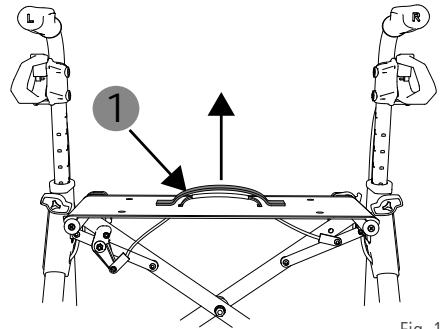

Fig. 10

## 4.8 TRANSPORT

Should it be necessary to transport the product, we recommend folding the rollator. The product should be packed so that it is standing in a stable position and there is no danger of the means of transport performing sudden and dangerous movements. If you need to carry the product, we recommend lifting the rollator when unfolded using the carrying strap on the seat cover.

- ▼ In this case, follow the instructions in the section "Folding and unfolding your rollator" and "Carrying your rollator".

- ▼ Carefully pack the rollator in a cardboard box when shipping it. When using trapezoidal boxes, make sure that they are positioned the right way round, i.e. with the straight long side facing downwards.
- ▼ Please inform yourself in advance about the conditions of the transport company for transport by plane or train.

## 4.9 STANDARD BAG (FITTED AS STANDARD)

The standard bag is approved for transporting objects up to a maximum weight of 5 kg. It features a magnetic bag suspension and a reflective logo on the front.

1. Grab the large grip loops on the long sides to attach the bag (1, Fig. 11). You can also grab the two small loops on the inside and use them for attachment.
2. Ensure that the side of the bag with the reflective logo is facing in the direction of travel.
3. Hold the magnets on the sides of the bag near their magnetic counterparts on the rollator so that they can engage (2, Fig. 11). Guide the bag to the bag suspension from below, if possible. You will hear a distinct snapping sound when the magnets are properly engaged.
4. Before filling the bag, make sure that it is properly attached.



### WARNING

**Sources of fire!** Please keep the bag away from sources of fire to prevent ignition.

**Risk of tipping!** Never exceed the maximum permitted weight of 5 kg in the standard bag, since this may cause the rollator to tip over. \_\_\_\_\_

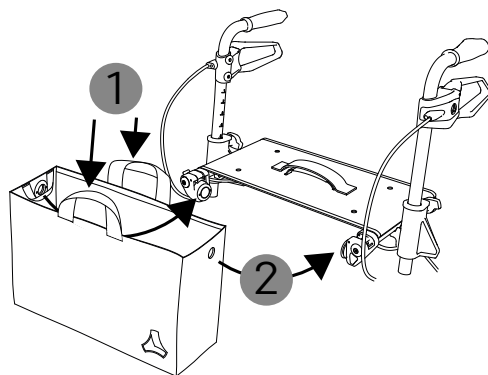

Fig. 11

5. If you want to detach the bag, take hold of the two large grip loops and pull the bag upwards out of the bag suspension. You can also use the small loops on the side to pull out the bag.



#### NOTE

**Pacemakers:** Users with a pacemaker are subject to the same conditions when using the standard bag as for all conventional bags with magnetic closures. Observe the user manual and the safety instructions of your pacemaker.

**Reflector position:** Make sure that you always hang the bag the right way round. The logo must point in the direction of travel.

**Swing of the bag:** It is possible that the bag can easily swing back and forth in the direction of travel. This is the result of the round pivot point of the bag suspension and is not a problem. \_\_\_\_

#### 4.10 PREMIUM BAG (OPTIONAL)

The premium bag is approved for transporting objects up to a maximum weight of 5 kg.

The principle of attaching and detaching the premium bag is the same as for the standard bag.

1. Grab the large grip loops on the long sides to attach the bag. You can also grab the two side tabs and use them for attachment.
2. Ensure that the straight side with the reflective zip is facing forward.



#### WARNING

**Sources of fire!** Please keep the bag away from sources of fire to prevent ignition.

**Risk of tipping!** Never exceed the maximum permitted weight of 5 kg in the premium bag, since this may cause the rollator to tip over. \_\_\_\_

3. Hold the magnets on the sides of the bag near their magnetic counterpieces on the rollator so that they can engage. Guide the bag to the bag suspension from below, if possible. You will hear a distinct snapping sound when the magnets are properly engaged.
4. Before filling the bag, make sure that it is properly attached.
5. If you want to detach the bag, take hold of the two large grip loops and pull the bag upwards out of the bag suspension. You can also use the small loops on the side to pull out the bag.
6. If the shoulder strap is not in use, the two tabs on the side can be tucked away in the open compartments on the top of the bag.

The premium bag features the following additional functions:

- ▼ Internal organiser compartments for storing smaller items, some with zips
- ▼ Organiser compartments open at the back, on the outside for items that can be accessed quickly
- ▼ Zip with "puller aid" on the large compartment for securely keeping your bag's contents inside
- ▼ Shoulder harness with padding, adjustable in length
- ▼ Reflective logo on the front
- ▼ High-quality, hard-wearing textiles

#### 4.11 BACK STRAP (OPTIONAL)

---

The back strap (Fig. 12, next page) allows you to seat yourself safely and helps you to find the correct position on the seat of the TAIiMA VENTUM.

It features reflective lettering (TAIiMA) on the outside and is padded on the inside. The back strap can be fitted at the height and depth to suit the user's needs.

The following describes correct fitting. Please contact your medical supply specialist in this case:

1. The back strap is fitted by screwing the brake handles to the push handles.
2. Both screws of the brake handle holder are loosened first (1, Fig. 12).
3. The back strap holder (2, Fig. 12) can now be fitted using the two matching holes.
4. The plastic element can be either aligned upwards (3, Fig. 12) or downwards (4, Fig. 12). This makes it possible to choose between two back height positions.
5. Once the back strap has been aligned as

you wish, you can fix it in place using the two screws (1, Fig. 12). Fully tighten the screws!

6. The depth of the back strap can be varied in two settings. In this case, loosen the screws connecting the back strap and the back strap holders (5, Fig. 12). The depth varies depending on the hole selected.
7. Reinsert the screws to the desired setting and tighten them. Ensure that you use the correct pair of holes (the respective front or rear holes of the back strap).



## WARNING

**Sources of fire!** Please keep the back strap away from sources of fire to prevent ignition.

**Risk of tipping!** Make sure that the brakes are locked before you sit down, and be aware that leaning against the back strap will reduce the tilt stability.



## NOTE

The seat is only designed to be used for short periods, i.e. when taking a short break when walking. For longer breaks, use conventional seating.

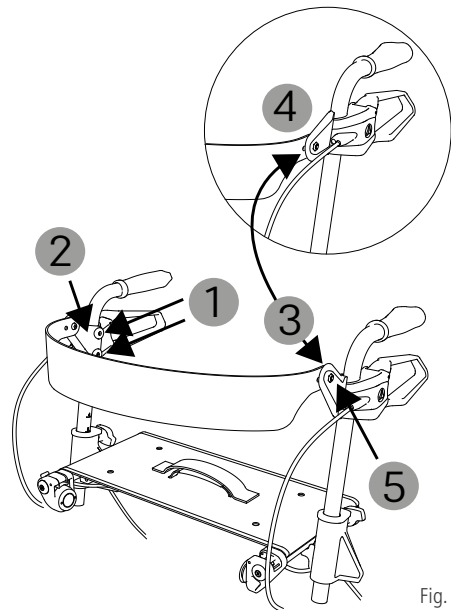

Fig. 12

## 4.12 CANE HOLDER (FITTED AS STANDARD)

The cane holder is mounted on the right side of your TAIIMA VENTUM.

1. To insert your walking stick, first position the rubber base of the walking stick in the lower section of the cane holder (1, Fig. 13).
2. Then use slight pressure to click the stick into the upper clip of the cane holder (2, Fig. 13).

If having the cane holder positioned on the left-hand side would be more practical for you, the upper and lower sections of the cane holder can be released and attached to the other side. Please contact your authorised medical supply specialist to have this installed.



### WARNING

**Safety hazard!** Always ensure that the walking stick is correctly positioned in the cane holder and that it cannot come loose when walking. \_\_\_

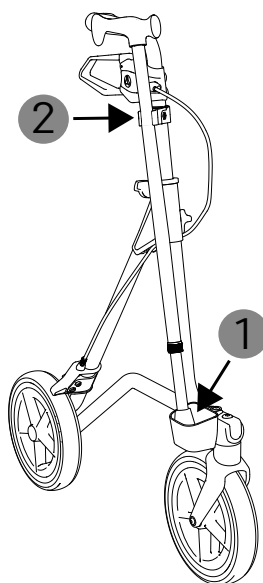

Fig. 13

## 4.13 TRAY (OPTIONAL)

The tray is designed for transporting small items up to a maximum of 5 kg but only for use indoors.

1. Only load the tray when it is placed on the rollator.
2. In order to position the tray on the rollator, grip it by the short sides (1, Fig. 14, next page).



### WARNING

**Risk of burns!** Do not use the tray to transport hot items or hot drinks. You could burn yourself if the transported items tip over.

**Danger of falling!** Only transport items that are lying or standing securely on the tray to avoid them falling off. \_\_\_\_\_

3. Place the tray on the seat cover as such that the four pins on the underside of the tray are positioned in the holes provided on the seat cover (2, Fig.14).
4. You can now carefully load the tray and push the rollator with extra care.



### WARNING

**Danger of falling!** Always push the rollator with extra care when the tray is loaded. If you make jerky movements, the objects on it could tip over or fall off.

**Safety hazard!** Always place or remove the tray on or off the rollator when it is empty. \_\_\_\_\_

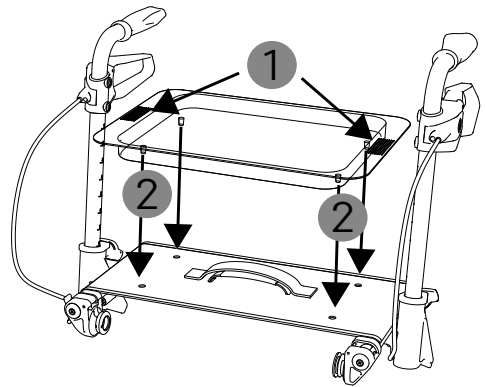

Fig. 14

## 4.14 ONE-HAND BRAKE SYSTEM (OPTIONAL)

If one of your hands does not have enough strength to safely apply the brake, the rollator can also be retrofitted with a one-hand brake system. This retrofitting on the rollator must be carried out by your medical supply specialist.

The same usage, maintenance and safety instructions apply as for the version with brake handles on both push handles.



### NOTE

Your rollator must only be fitted with a one-hand brake system if the hand with which the brake will be operated is sufficiently strong. This is the only way of ensuring the safe handling of the rollator. \_\_\_\_\_

### 4.15 EXTENDED PUSH HANDLES (OPTIONAL)

---

The TAIiMA VENTUM can be equipped with extended push handles. This is advisable if you are not able to walk upright when pushing the rollator due to your size.

Please contact your authorised medical supply specialist to have this installed.

Setting the push handle height, using the brakes and adjusting the brakes are performed in exactly the same way as for conventional push handles. In this case, read the sections "Adjusting the grip height", "Applying the service brakes", "Applying the parking brakes" and "Brake adjustment".



#### WARNING

**Risk of tipping!** Fitting extended push handles can have a negative effect on the tilt stability of your rollator!

**Safety hazard!** Please contact your medical supply specialist to have extended push handles fitted as only correct attachment will ensure safe handling. \_\_\_\_\_

### 4.16 UMBRELLA (OPTIONAL)

---

Your TAIiMA VENTUM can be equipped with an umbrella for use as rain and sun protection.

The installation of this umbrella is described in a separate user manual supplied with the umbrella. Have the umbrella fitted by your medical supply specialist, who will hand over the user manual to you.



#### WARNING

**Risk of tipping!** Fitting an umbrella may negatively affect the tilt stability of your rollator!

**Safety hazard!** Please observe all usage and safety instructions stated in the separate user manual for the umbrella! \_\_\_\_\_



## 4.17 ACCESSORIES AND ADD-ONS / CONVERSIONS FROM EXTERNAL SUPPLIERS

---

Generally, only original accessories from DIETZ GmbH are permitted to be used. If third-party products are installed on the product, responsibility for the safety of the product passes to the person who installs the accessories or fits the add-on/conversion. In this case, the installer or convertor must issue a new declaration of conformity for the combination of accessories or add-on and product. The conformity declared by DIETZ GmbH according to MDR 2017/745, Annex II is rendered null and void.



### WARNING

**Safety hazard:** The safety of the product cannot be guaranteed if add-ons/conversions or accessories are sourced from anyone other than DIETZ GmbH. If accessories or add-ons/conversions are fitted to the product, then the safety instructions in the user manual for the accessories or add-ons/conversions must always be observed.

---

## 5.1 DIMENSIONS AND TECHNICAL INFORMATION

Description		Unit	TAiMA VENTUM
Length / width / height		mm	680 / 625 / 950
Length / width / height when folded		mm	680 / 240 / 840
Seat height / seat width / seat depth		mm	610 / 420 / 200
Total height min. / max.		mm	775 / 950
Grip height, adjustable		mm	7 steps × 25
Grip distance		mm	420
Turning width		mm	880
Wheel size		mm	220 x 32
Tilt stability EN ISO 11199-2	forward	°	> 15
	backwards	°	> 7
	sideways	°	> 3.5
Weight without / with options		kg	7.7 / 8.2
Maximum user weight incl. additional load		kg	150
Max. Load capacity of options		kg	Tray: 5 Standard bag: 5 Premium bag: 5
Recommended body height		m	1.60 – 1.85

## 5.2 PRODUCT TESTS

Standard	
EN ISO 11199-2	The standards for technical aids for walking for use with both arms, rollators have been tested
ISO 10993-5	tested for toxicity in the material

## 5.3 FURTHER INFORMATION

Model (colour specifications)	amarena	cashmere
Item number	200165	200166
HMV no. (Therapeutic Appliance Register)	10.50.04.1264	
Ambient temperature during operation (entire rollator as well as Dietz options)	+10°C to +40°C.	
Ambient conditions of storage (entire rollator as well as Dietz options)	0°C to +45°C // 20% to 75% relative humidity	

## 5.4 MATERIALS / COLOURS

Component	Colour	Material
Frame	amarena cashmere	Aluminium (Al), painted
Wheels	black	Rim: Polypropylene (PP) + 20% glass fibre (GF) Tyres: Polyurethane (PUR)
Brake handles	black	Polyamide (PA) + 30% glass fibre (GF)
Handles	black	Thermoplastic elastomers (TPR)
Seat cover	black	100% polyester (PES) + polyvinyl chloride (PVC) coating
Standard bag	amarena / black cashmere / black black	100% polyester (PES) + polyvinyl chloride coating (PVC)
Premium bag	black / label amarena black / label cashmere	100% polyester (PES) + polyurethane (PU) coating
Back strap	amarena cashmere black	100% polyester (PES) + polyvinyl chloride (PVC) coating

**Note:** All metals used are corrosion-resistant.

## 5.5 PRODUCT LABELLING

The product label and warning signs on the product must remain legible. Please have illegible or missing signs replaced immediately by your specialist retailer. The serial number sticker is very important for identifying the product, it is placed on the product label, which is placed below the seat. It must not be removed.

Products with the following designation are custom models:

Custom-made devices are products which have been made specifically for a particular user. In this case, the product label, warnings on the product and possibly also the intended purpose will differ compared to a standard device. It is essential to observe the additional documentation!

**SONDERANFERTIGUNG  
CUSTOM-MADE DEVICE**

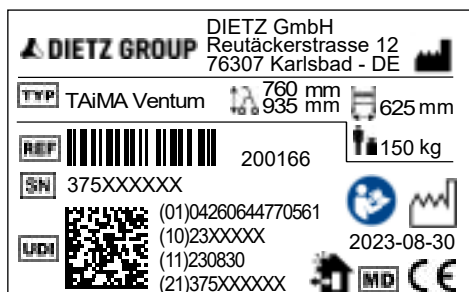

Fig. 15

	Trademark
	TYPE = model
	REF = Item number
	SN = serial number
	UDI = Unique Device Identifier (01) UDI-DI/GTIN (10) Batch/lot number (11) Date of manufacture (YYMMDD) (21) Serial number
	Manufacturer/manufacturer's logo/contact address
	Maximum user weight incl. additional load
	Date of manufacture (YYYY-MM-DD)
	Total width of rollator
	Total height (min. – max.) Rollator
	The rollator can be used indoors and outdoors
	Follow the instructions for use
	Medical Device
	The product is compliant with Regulation (EU)2017/745 on medical devices

## 6.1 SAFETY INSTRUCTIONS

When using the product, always observe the following safety instructions to prevent falls, hazardous situations and damage to the product:

- ▼ Carefully read the user manual before using the rollator!
- ▼ The rollator may only be used on firm, level ground.
- ▼ Use the service brake on sloping paths (pull the brake lever upwards in a measured manner).
- ▼ The rollator must stand securely on all four wheels.
- ▼ Before each use of the rollator, check that all attached parts are firmly in place, that the brakes are working and that the rollator is fully unfolded and fixed in this position.
- ▼ Always apply both parking brakes before sitting on the rollator's seat.
- ▼ The rollator's seat is only designed to be used for short periods, such as when taking a break when walking.
- ▼ The back strap of the rollator does not serve as a backrest, but is used for easier positioning on the seat.
- ▼ Attention: please note that a shift of balance due to body movements may increase the risk of the rollator tipping over. Always make sure the load on the rollator is even.
- ▼ Do not hang any bags on the handles or other parts of the rollator, since this will increase the risk of it tipping over.
- ▼ When unfolding/folding the rollator, take care not to trap your hands, fingers, and clothing in the mechanism! There is a risk of getting them trapped.
- ▼ Never exceed the maximum load of 150 kg for users, incl. additional loads.
- ▼ Avoid exposing the rollator to direct sunlight, heat sources and low temperatures for long periods of time as parts of the product (e.g. frames or handles) may become very hot ( $> 41^{\circ}\text{C}$ ) or very cold ( $< 0^{\circ}\text{C}$ ) and this may cause skin injuries.
- ▼ Ensure that the rollator is not parked in direct vicinity of emergency exits and escape routes or blocking them.
- ▼ Never use the rollator under the influence of alcohol or other substances that can negatively affect your attention and reaction ability.
- ▼ Only ever use the rollator in accordance with its intended use.
- ▼ When using the rollator, never approach obstacles such as steps or curbs without applying the brakes. The rollator must not be left for children to play with and must not be subjected to improper use.



### WARNING

**Safety instructions:** Failure to follow all of the safety instructions can result in injury! \_\_\_\_\_

- ▼ When sitting on the rollator, you must not walk with your feet or be pushed by other persons. This is an injury risk and may cause damage to the product.
- ▼ Observe the road traffic regulations when out and about on public streets.
- ▼ Wherever possible, wear light-coloured, eye-catching clothing and make sure that the reflectors are intact and visible.
- ▼ Never use the rollator as a seat in a vehicle or on public transport. This poses an increased danger of falling.
- ▼ Never use escalators when on the Rollator, as this causes an increased danger of falling and injury.
- ▼ Stairs must only be negotiated with the help of accompanying persons if no elevators or ramps are present.
- ▼ The wheel bearings can be damaged by sand, seawater and road salt. Clean the rollator thoroughly (in accordance with the section "Cleaning") if it has been exposed to conditions such as these.
- ▼ If they cannot be bypassed, ruts, rails or similar obstacles must always be crossed at right angles (90°).
- ▼ The rollator must not be used as a climbing aid, transport aid for heavy loads or for similar purposes. The standard or premium bag and the tray can be used to transport objects weighing up to 5 kg.
- ▼ Never climb on the rollator and never use it as a climbing aid or the like.
- ▼ Please take your rollator immediately to your medical supply specialist for repair if you notice any impairments of its functions.
- ▼ If stored for over one year, all mandatory inspections stipulated in the maintenance schedule must be performed before putting the rollator back into service.
- ▼ Do not sit on the rollator undressed for hygienic reasons.
- ▼ Keep the rollator away from potential sources of heat and fire.
- ▼ Serious incidents that occur in relation to the product must be reported to the manufacturer and the responsible authorities.
- ▼ Immediately consult a doctor if redness, inflammation or irritation of the skin develops in connection with using the product.

## 7.1 SERVICING/MAINTENANCE

---

We recommend performing the inspections listed in the maintenance schedule at regular intervals to ensure that the product is always safe to use.

Improper or insufficient product care and maintenance will result in restricted liability on the part of the manufacturer. The maintenance schedule does not provide any information on the amount of work that will actually need to be performed on the product.



### NOTE

As the user, you will be the first to notice any damage. If you notice a fault as described in the maintenance schedule or further defects and functional impairments, contact an authorised specialist retailer immediately. \_\_\_\_\_



### WARNING

To maintain the operational safety of the product, repairs must only be performed by medical supply specialists using DIETZ original spare parts. The relevant spare parts catalogue can be found on our website by looking under the information for the product concerned. \_\_\_\_\_



### NOTE



Unless otherwise stated, the inspections and measures stipulated in the maintenance schedule must be performed by the user or their care assistant. \_\_\_\_\_



### NOTE FOR SPECIALIST RETAILERS

If the user reports product abnormalities, please check all the inspection points listed in the maintenance schedule. The checks must also be performed before putting the rollator back into operation and after longer storage periods (> 4 months). \_\_\_\_\_

## 7.2 MAINTENANCE SCHEDULE

What to check	Description	Monthly	
		Before use	
<b>Brakes/parking brakes:</b> Function	<ul style="list-style-type: none"> <li>• If the brake handles are pushed down / locked (parking brake) or fully applied (service brake), the rear wheels must not turn.</li> <li>• When the brake handles are in the neutral position, the wheels must turn easily without any noise.</li> <li>• The brake handles must be intact.</li> <li>• The lock nut of the adjusting screw at the bottom of the brake must always be tightened.</li> </ul>  The brakes must be reconfigured after replacing the Bowden cables or rear wheels. This must only be carried out by the medical supply specialist.	x	
<b>Push handles:</b> Stability	<ul style="list-style-type: none"> <li>• It must be possible to firmly lock the locking screws for adjusting the height of the push handles.</li> <li>• The push handles must not wobble.</li> </ul>	x	
<b>Folding lock, folding mechanism and folding lock hooks:</b> Function & safety	<ul style="list-style-type: none"> <li>• It must be easy to push the two frame parts together and apart.</li> <li>• The folding lock hook must be intact and it must be easy to slip it over the counterpiece.</li> <li>• When in an unfolded state, the folding lock must snap into place when the seat tubes are pushed apart or pressed down.</li> <li>• The grey strap that is used to unlock the folding lock must be intact and it must be easy to pull it upwards, releasing the folding lock.</li> </ul>	x	
<b>Screw and rivet connections:</b> securely fastened	<ul style="list-style-type: none"> <li>• All screw and rivet connections must be securely fastened.</li> </ul>  Self-locking nuts and screws lose their efficacy through being repeatedly released and tightened. These must therefore be replaced by the medical supply specialist if they become loose.	x	
<b>Steering and running wheels:</b> Mobility, function & damage	<ul style="list-style-type: none"> <li>• The wheels must run in a straight line and must not wobble.</li> <li>• The wheels must move easily and with little noise when travelling.</li> <li>• The wheels must not be damaged.</li> <li>• Please clean the wheel hub if there is fluff or contamination in it.</li> <li>• The rear wheel cover caps must be present.</li> </ul>	x	



What to check	Description	Monthly	
		Before use	
<b>Push handles:</b> Stability & damage	<ul style="list-style-type: none"> <li>The handles and brake handles must be firmly secured.</li> <li>The push handles must not have any external damage/distortion and must not wobble.</li> <li>The locking screws for height adjustment must be present on both sides and it must be possible to tighten them firmly.</li> <li>It must be easy to adjust the height of the push handles and they must be able to engage in the marked steps.</li> </ul>		x
<b>Frame, entire:</b> Function & damage	<ul style="list-style-type: none"> <li>The two frame parts and cross brace must not be damaged or cracked.</li> <li>Functional damage or surface damage must be rectified.</li> </ul>		x
<b>Seat surface:</b> Contamination & damage	<ul style="list-style-type: none"> <li>The seat cover must be firmly positioned in the side rails.</li> <li>If contamination is found, clean the seat in line with the cleaning instructions.</li> <li>If damaged, have the seat replaced.</li> </ul>	x	
<b>Standard and premium bag:</b> Contamination & damage	<ul style="list-style-type: none"> <li>Have the bag replaced if it is damaged.</li> <li>If contamination is found, clean the bag in line with the cleaning instructions.</li> <li>The magnetic bag suspension on the bag and rollator must be tight and it must work without any problems.</li> </ul>	x	
<b>Cane holder:</b> Contamination & damage	<ul style="list-style-type: none"> <li>The upper &amp; lower parts of the cane holder must be undamaged.</li> <li>The cane holder must be securely fixed to the rollator at the right position.</li> <li>It must be easy to position the walking stick in the cane holder.</li> <li>If contamination is found, clean the cane holder in line with the cleaning instructions.</li> </ul>	x	
<b>Back strap:</b> Contamination & damage	<ul style="list-style-type: none"> <li>The back strap must be firmly bolted to the push handles.</li> <li>The back strap must not be damaged.</li> <li>If contamination is found, clean the back strap in line with the cleaning instructions.</li> </ul>	x	
<b>Tray:</b> Contamination & damage	<ul style="list-style-type: none"> <li>The tray must not be damaged. The four positioning pins on the underside in particular must be intact.</li> <li>If contamination is found, clean the tray in line with the cleaning instructions.</li> </ul>	x	
<b>Umbrella:</b> Contamination & damage	<ul style="list-style-type: none"> <li>The umbrella must be securely fixed to the rollator following the instructions in the separate user manual.</li> <li>If contamination is found, clean the umbrella in line with the cleaning instructions.</li> </ul>	x	
<b>Checking the type plate</b>	<ul style="list-style-type: none"> <li>All information on the type plate must be easily legible.</li> </ul>		x
<b>Checking the reflectors</b>	<ul style="list-style-type: none"> <li>All reflectors (bolted plastic reflectors &amp; reflector stickers) must be intact and present.</li> </ul>	x	

What to check	Description	Monthly	
		Before use	
<b>Visual inspection:</b> Loose parts, fractures, corrosion or other damage	 If this type of damage is detected, the rollator must no longer be used, as safe operation is no longer guaranteed!		x
<b>Entire product:</b> Check for contamination	The entire rollator must be cleaned depending on how dirty it is, but at least once a month (see section "Cleaning").		x

### 7.3 TROUBLESHOOTING

What	Possible causes	Measures
The product does not move in a straight line.	<ul style="list-style-type: none"> <li>The wheel bearings are defective or the wheel suspensions are no longer correctly attached.</li> </ul>	Consult your medical supply specialist
The product is difficult to push.	<ul style="list-style-type: none"> <li>The wheel axles/wheel hubs are dirty.</li> </ul>	Remove the dirt
	<ul style="list-style-type: none"> <li>The brakes are set incorrectly.</li> <li>The wheel bearings are defective or the wheel suspensions are no longer correctly attached.</li> </ul>	Consult your medical supply specialist
The brake function is insufficient or uneven.	<ul style="list-style-type: none"> <li>The brakes are incorrectly adjusted or the brake pad has worn out.</li> </ul>	Consult your medical supply specialist
The seat cover is not taut or not firmly connected to the rollator.	<ul style="list-style-type: none"> <li>The rollator is not fully unfolded.</li> </ul>	Fully unfold the rollator and engage the folding lock.
	<ul style="list-style-type: none"> <li>The seat cover is not correctly fixed in the side rails or is defective.</li> </ul>	Consult your medical supply specialist
	<ul style="list-style-type: none"> <li>The cross brace or folding mechanism are defective.</li> </ul>	

What	Possible causes	Measures
The product does not provide secure support or does not stand reliably.	<ul style="list-style-type: none"> <li>The push handles are not fixed in place properly or have been incorrectly adjusted for the user.</li> </ul>	Check the position of the push handles. Check whether the locking screws on the push handles are securely tightened.
	<ul style="list-style-type: none"> <li>The rollator has not been fully unfolded and the folding lock has not been engaged.</li> </ul>	Fully unfold the rollator and engage the folding lock
	<ul style="list-style-type: none"> <li>The rollator frame or the push handles are damaged.</li> </ul>	Consult your medical supply specialist
Squeaking and grinding noises	<ul style="list-style-type: none"> <li>Various causes</li> </ul>	Consult your medical supply specialist
The bag can no longer be hooked on.	<ul style="list-style-type: none"> <li>The magnetic bag suspension is defective or has become loose.</li> </ul>	Consult your medical supply specialist
	<ul style="list-style-type: none"> <li>Part of the magnetic bag suspension has been lost.</li> </ul>	

## 7.4 CLEANING

---

To clean the TAIiMA VENTUM and its components, use lukewarm water mixed with a mild cleaning agent (without solvents and with a pH value of 5-9).

After cleaning, wipe with clear water and then dry the rollator with a cloth. The wheels can be cleaned using a damp brush with soft plastic bristles (do not use a wire brush!).

The seat cover, back strap, standard and premium bag can be hand-washed in mild soapy water of up to 30°C. Remove contamination and fluff from the wheel hubs.

## 7.5 DISINFECTION

---

Wipe down or spray all parts thoroughly with a commercially available surface disinfectant. Take particular care to disinfect surfaces that come into frequent contact with hands/skin, such as the seat surface, handles and brakes.

Please only use the following disinfectants; use of other chemicals might damage the rollator:

- ▼ Aldehyde-free disinfectants based on alcohol (max. 70% propylalcohol)

## 7.6 DISPOSAL

---

The product is made of aluminium and plastic materials that can be recycled just like the packaging material (cardboard). If you no longer need the product, please contact a medical supply specialist. They will pick up the rollator and either dispose of it properly or make further use of it. Otherwise, please take the rollator to



### WARNING

**Material damage:** Do not use high-pressure cleaners, strong or corrosive chemicals or scouring agents for cleaning purposes.

**Risk of corrosion:** To avoid corrosion, ensure that all materials dry completely after cleaning. ...



### WARNING

**Material damage:** Observe the use and processing instructions issued by the cleaning agent/disinfectant manufacturer.

**Risk of infection:** The product must be disinfected before each user change. ...

your local waste disposal facility.

## 7.7 PASSING ON THE PRODUCT FOR REUSE

---

Your product is suitable to be passed on for reuse by others. The number of times it can be reused depends on the material wear conditions and the functional capabilities of the respective product. When passing on the product for reuse, please remember to hand over all the technical documents necessary for safe handling and use to the new user or the medical supply specialist. Before it is reused, the product must be cleaned, disinfected, checked for damage and approved by a medical supply specialist.

As part of this, all the inspection points listed in the maintenance schedule must be checked on the product.

## 7.8 STORAGE

---

If you wish to store the product, ensure that it is kept in a dry place protected against direct, strong sunlight and at a temperature of 0°C to +45°C.

Secure the rollator against rolling away unintentionally. In this case, do not use the parking brakes, since they can cause damage to the tyres over a long period of time when applied.

After longer periods of storage (>4 months), please check all the inspection points on the product as listed in the maintenance schedule before reusing/redeploying the product.



### WARNING

**Risk of infection:** The product must be disinfected before each change of user. This is important for avoiding cross-contamination.



### NOTE

If the product is designated as custom-made, it must not be passed on for reuse. \_\_\_\_\_



### WARNING

Do not store the product near a heat source and do not place any objects on the product during storage.

## 8.1 WARRANTY

---

The warranty covers all product defects which are verifiably attributable to material or manufacturing flaws. The warranty period is 24 months as of receipt of notification of readiness for shipping, but following delivery at the latest. The warranty does not cover damage which has

occurred due to natural wear and tear, or has been caused deliberately or through negligent or improper operation or use. This also applies to the use of unsuitable care products, lubricating oils or greases.

## 8.2 SERVICE LIFE

---

The product has an expected service life of five years when used daily and exactly as intended. This assumes compliance with the maintenance and safety instructions stipulated in this user

manual. The indicated service life does not constitute any kind of additional warranty.

## 8.3 LIABILITY

---

DIETZ GmbH is only liable if the product is used under the specified conditions and for the specified purpose. It is very important to handle and care for the products properly as per the instructions. DIETZ GmbH is not liable for damage

caused by components and spare parts that have not been approved by DIETZ GmbH. Repairs must only be carried out by medical supply specialists or by the manufacturer itself.



**Product group: Rollators**

**Product: TAiMA VENTUM**

User manual version 1.0 EN

As of 2023-11 (LFI)

**DIETZ GmbH**

Reutäckerstraße 12

76307 Karlsbad

Germany

Tel.: +49 7248.9186-0

Fax: +49 7248.9186-86

info@dietz-group.de

www.dietz-group.de

Printing errors, mistakes, price and product changes reserved.

© DIETZ GmbH, Karlsbad

Not to be reproduced, whether in part or in whole, without the written approval of DIETZ GmbH, Karlsbad.



**DIETZ GmbH**

Reutäckerstrasse 12

76307 Karlsbad

Germany