

TOMTAR

Order form BASIK



**Crashtest nach
ISO 7176-19**
Zugelassen für den
Personentransport
im Fahrzeug

Shaping mobility.

Completing the form on paper

Simply print out the order form, check the relevant component boxes to configure the product, sign the form and send it to us at:

Fax: +49 7248.9186 - 86

Completing the form on a computer or tablet

The screenshot shows a PDF form titled "Bestellbogen" (Order Form) in a PDF viewer. The form has a header "Bestellbogen" and a section "Angaben zur Bestellung:" (Order details). Below this, there are several input fields and checkboxes. The "Auftrag" checkbox is checked, while "Angebot Bauh VK" and "Angebot Bauh TK" are unchecked. The "Name des Patienten/Kommission" field is also visible.

If you open the document in Acrobat, a menu bar highlighted in colour appears at the top edge.

If the option „Highlight Existing Fields“ is activated, all writeable and selectable fields will be displayed.

- Circular check boxes indicate that a choice must be made for the given component.
- Circular filled selection fields indicate that these options are included in the standard.
- Square check boxes can simply be selected or deselected

Save the form on your computer under any name you choose and

e mail it to us at:

info@dietz-reha.de

Alternatively, print it out and send it to us at:

Fax: +49 7248.9186 - 86

BASIK

Standard folding wheelchair



| Technical data | with locking brake | with drum brake |
|--|------------------------|-----------------|
| Colour | Mangan Grey Metallic | |
| Seat width (cm) | 39 / 42 / 45 / 48 / 51 | |
| Seat depth * (cm) | 40 / 44 | |
| Seat height * (cm) | 46 / 48,5 / 51 | |
| Overall width (cm) | 59 / 62 / 65 / 68 / 71 | |
| Overall height (cm) | 94,5 | |
| Overall length *(cm) | 106-108 | |
| Overall length without legrest (cm) | 80 | |
| Overall width folded (cm) | 31 | |
| Armrests height without cushion * (cm) | 22 / 23,5 / 25 | |
| Armrests width (cm) | 4,5 | |
| Lower leg length * (cm) | 35 - 47 | |
| Driving wheels (Durchmesser Zoll) | 24 | |
| Castor wheels (Diameter Zoll) | 7 | |
| Maximum Capacity (kg) | 130 | |
| Weight ** (kg) | 18,5 | |

* settable

** exemplary weight for seat depth 45 cm with leg rests, without drum brake

Product details

Basic configuration

- Driving wheels 24" PU, inclusive shaft, Aluminium push rims
- Castor wheel 7" PU
- Side panels folding upwards and removeable
- PU-Armpad, settable in length (Desk / Long) and height (3cm)
- Leg rests rotatable and detachable
- Foot plate settable in height
- Heel strap settable (velcro)
- Seat depth settable (40 / 44 cm)
- Drum brake selectable as Option available
- Crash tested according to ISO 7176-19, approved for passenger transport in vehicles sitting in a wheelchair

Order form BASIK

Details of your order:

| | | |
|----------------------------|------------------------------|-------------------------------|
| Healthcare supply store | | |
| Customer no. | | |
| Order | Offer based on selling price | Offer based on purchase price |
| Name of patient/commission | | |
| Delivery address | | |
| Comments | | |
| Company stamp | | |
| Date, signature | | |
| | | |

Order form BASIK

Key dimensions and specifications

Together with the height and weight of the user, these are the key dimensions allowing us to align the wheelchair perfectly to the needs of the user.

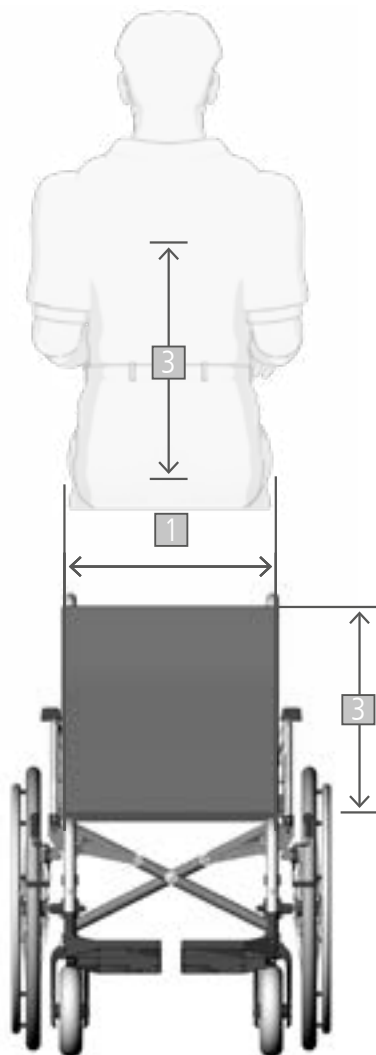
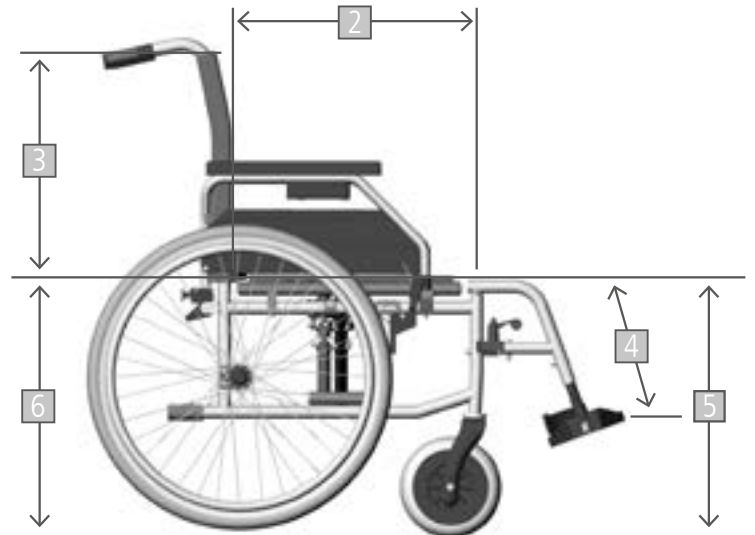
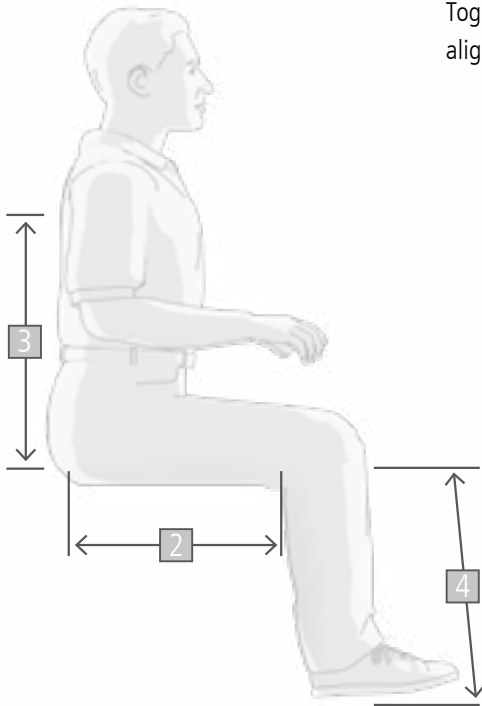

| WERTE | | |
|-------|---|--|
| | Age of customer | |
| | Height (cm) | |
| | Weight (kg) | |
| 1 | Seat width (cm) | |
| 2 | Seat depth (cm) Length of upper leg less two finger breadths | |
| 3 | Height of upholstered back rest (cm) From seat surface to below the shoulder blades | |
| 4 | Lower leg length (cm) For the correct height of the foot plate | |
| 5 | Seat height, front (cm) Length of lower leg + sufficient clearance between foot plate and ground (at least 4 cm) | |
| 6 | Seat height, back (cm) Depends on front seat height, seat angle and seat depth | |

Order form BASIK

| Description | Seat width |
|-------------|------------|
|-------------|------------|

SELECT THE RIGHT SEAT WIDTH

| Seat width (cm) | 39 | 42 | 45 | 48 | 51 | |
|---|----------|---------------|---------------|---------------|---------------|---------------|
| With locking brake | Item no. | 102039 | 102042 | 102045 | 102048 | 102051 |
| | EUROS* | 559,00 | 559,00 | 559,00 | 559,00 | 699,00 |
| With drum brake + locking brake | Item no. | 102139 | 102142 | 102145 | 102148 | 102151 |
| | EUROS* | 759,00 | 759,00 | 759,00 | 759,00 | 899,00 |
| No tools are needed to reconstruct the seat depth from 40 cm to 44 cm - independent of seat with. | | | | | | |

| Selection | Item no. | Description | Comment | EUROS* |
|-----------|----------|-------------|---------|--------|
|-----------|----------|-------------|---------|--------|

SELECT SEAT HEIGHT

| | | | |
|---|---------------------|-----------|--------------|
| Standard | Seat height 51 cm | assembled | 00,00 |
| 999949 | Seat height 48,5 cm | assembled | 25,00 |
| 999946 | Seat height 46 cm | assembled | 25,00 |
| The modification can be done by your specialist retailer without additional Material. | | | |

WHEELBASE EXTENSION

| | | | |
|--------|---|-----------|--------------|
| 196243 | Modification to a 6,5 cm extension of wheelbase | assembled | 39,00 |
|--------|---|-----------|--------------|

SELECT LEGREST

Standard legrest

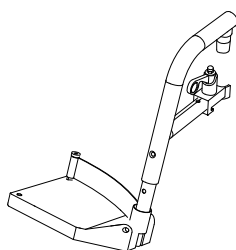

Legrest for amputees

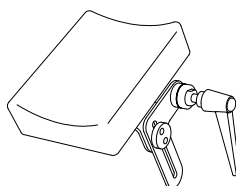

Elevating legrest

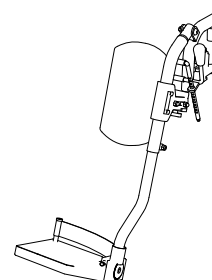

| | | | | |
|--|----------|--|-----------|---------------|
| | Standard | Standard legrest / left, foot plate adjustable in height | assembled | 00,00 |
| | Standard | Standard legrest / right, foot plate adjustable in height | assembled | 00,00 |
| | 196235 | Legrest for amputees, left | assembled | 106,00 |
| | 196234 | Legrest for amputees, right | assembled | 106,00 |
| | 196228 | Elevating legrest, SW 39, left | assembled | 135,00 |
| | 196229 | Elevating legrest, SW 39, right | assembled | 135,00 |
| | 196230 | Elevating legrest, SW 42-45, right | assembled | 135,00 |
| | 196231 | Elevating legrest, SW 42-45, left | assembled | 135,00 |
| | 196232 | Elevating legrest, SW 48-51, right | assembled | 135,00 |
| | 196233 | Elevating legrest, SW 48-51, left | assembled | 135,00 |

Order form BASIK

OPTIONS OF POSITIONING

| Description | | seat width | | | | |
|---|----------|--------------------------------------|--------------|--------------|--------------|--------------|
| seat width (cm) | | 39 | 42 | 45 | 48 | 51 |
| Wheelchair set (cane holder, seat belt, seat cushion) | item no. | 196245 | 196246 | 196247 | 196248 | 196248 |
| | EUROS* | 65,00 | 65,00 | 65,00 | 65,00 | 65,00 |
| Sito standard cushion seat depth 42 cm black height 5 cm | item no. | 196261 | 196262 | 196263 | 196264 | 196264 |
| | EUROS* | 26,00 | 26,00 | 26,00 | 29,00 | 29,00 |
| Sito standard cushion seat depth 44 cm black height 5 cm | item no. | not available for this seat width | | 196265 | 196266 | 196266 |
| | EUROS* | | | 28,00 | 29,00 | 29,00 |
| Sito incontinence cover for sito standard cushion height 5 cm | item no. | not available for this seat width | | 196267 | 196268 | 196269 |
| | EUROS* | | | 23,00 | 23,00 | 25,00 |

| Selection | Item no. | Description | Comment | EUROS* |
|-----------|----------|--|-----------|---------------|
| Standard | | Side frame, (pair) kombi desk + long, adjustable in height | assembled | 00,00 |
| | 196244 | Side frame, (pair) PU-Support angled, adjustable in height | assembled | 148,00 |

Side frame standard

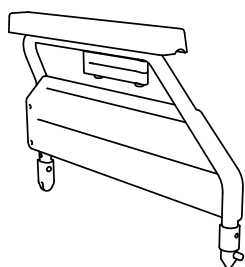

Side frame PU-Support angled

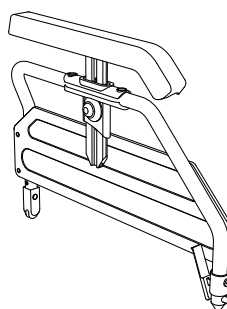

Order form BASIK

| Selection | Item no. | Description | Comment | EUROS* |
|-----------|----------|-------------|---------|--------|
|-----------|----------|-------------|---------|--------|

BASIC MODEL OPTIONS ACCORDING TO SEAT WIDTH

| | | | | |
|--------|--|---------------|--|-----------------|
| 470060 | Activity Tray (SW 39 – 45 cm) | | | 95,00 |
| 470061 | Activity Tray (SW 48 + 51 cm) | | | 115,00 |
| 860-10 | PD-6 A, electrical pushing aid 12V/12Ah (SW 39-42 cm) | assembled | | 2.958,00 |
| 860-11 | PD-6 A, electrical pushing aid 12V/12Ah (SW 45-51 cm) | assembled | | 2.958,00 |
| 196252 | Headrest complete with clamp (SW 42 – 51 cm) | | | 319,00 |
| 195060 | Headrest incl. bracket, (SW 39-42) for transportation in a vehicle | (ISO 7176-19) | | 503,40 |
| 195061 | Headrest incl. bracket, (SW 45-51) for transportation in a vehicle | (ISO 7176-19) | | 503,40 |

VARIOUS OPTIONS FOR ALL SEAT WIDTH

| | | | | |
|--------|--|-----------|--|---------------|
| 196236 | Anti-Tip-Wheels left | assembled | | 39,00 |
| 196237 | Anti-Tip-Wheels right | assembled | | 39,00 |
| 196240 | Brake lever extension for locking brake, pear | assembled | | 29,90 |
| 198069 | Wheel cover transparent for wheel 24", incl. mounting parts | assembled | | 38,00 |
| 196260 | Walking stick holder with Clamp for 25 mm pipe diameter | | | 15,00 |
| 196238 | Belt for seat width 39 - 45 cm | | | 24,00 |
| 196239 | Belt for seat width 48 - 51 cm | | | 24,00 |
| 190053 | Infusion holder for wheelchair, approx. 100 cm, 2 hooks | | | 139,00 |
| 196256 | Cover for Handrails for wheel 24" silicone black/fluted | | | 59,00 |
| 196257 | Cover for Handrails for wheel 24" silicone black/slick | | | 59,00 |
| 196259 | Folding blocker black | | | 54,00 |
| 400651 | String bag for folding wheelchair, black | | | 9,90 |

§1 General Information

1. Our General Commercial, Delivery and Payment Terms shall apply exclusively. All incidental agreements to these Terms and Conditions, even if they are accepted by representatives or employees, shall be confirmed by us in writing in order to become valid. The General Terms and Conditions of the purchaser shall only apply if we have expressly agreed to them in writing.

2. The invalidity of any individual provisions of these Terms and Conditions shall not render these Terms and Conditions invalid as a whole.

§2 Quotations and Conclusion of Contracts

1. Our quotations shall be subject to confirmation. Orders shall only be binding on our company when we confirm them or send the goods. Incidental oral agreements shall only be valid when we confirm them in writing.

2. Confirmation of the order shall obligate the purchaser to accept the goods shown in the order confirmation.

3. The order shall normally be placed in writing (also by fax). If an order is only issued orally, transmission errors or misunderstandings shall be the responsibility of the purchaser. If a written order exists, the volume and contents of the order shall be based on this order.

§3 Delivery and Delivery Periods

1. The goods shall be delivered in the specified designs and packing units. We reserve the right to make partial deliveries.

2. We shall not be obliged to deliver goods as long as the purchaser is in arrears with his payment.

3. If an agreed delivery period is culpably exceeded, default in delivery shall only exist after granting a reasonable period of grace which shall start when we receive the notice granting this period of grace. If we fail to deliver the goods on time due to reasons for which we are responsible, the purchaser shall be entitled to demand for every full week of the delay default compensation amounting to 0.5%, but at most up to 5% of the invoice value of the goods and services affected by default. Any change in the burden of proof to our detriment shall not apply to the above-mentioned regulation. Any further claims shall be excluded, unless default is due at least to gross negligence.

§4 Force Majeure

1. In the case of force majeure, e.g. strikes, lockouts or other events which we are unable to avoid despite having taken a reasonable degree of care given the circumstances and which affects either our business or that of a supplier, the contractual obligations of the contracting parties shall be suspended for the duration and extent of the disruption.

2. If the resulting delays exceed a period of six weeks, both contracting parties shall be entitled to cancel the contract in respect of the affected goods and services. No other claims shall apply.

§5 Prices and Payment Terms

1. The prices listed (in euros) in our sales literature (catalogues, order price lists, etc.) shall be valid at the time of publication. Promotional prices shall only be valid during each specified time period. We reserve the right to change prices after the publication of sales literature. If contracts have already been concluded, there shall be no change in the agreed price.

2. The prices shall apply ex works Germany, excluding packaging.

3. Statutory VAT shall not be included in our prices. The amount of statutory VAT applying on the date of issue of the invoice shall be shown separately on the invoice. The purchaser shall be in arrears without a warning.

4. Unless otherwise stipulated in the order confirmation, our invoices shall be paid without deduction within 10 days. The service period shall be shown on the invoice. The purchaser shall be in arrears without a warning.

5. If the period for payment is exceeded, we shall be entitled to charge – from the start of default – default interest amounting to at least 4% per annum. Both the purchaser and our company reserve the right to provide proof of lower or higher damage in individual case.

6. If the purchaser is in arrears and there are justified doubts concerning his ability to pay or his creditworthiness, we shall be entitled to demand securities or advance payments for outstanding deliveries, immediately assert all claims arising from the business relationship and take back goods supplied under reservation of title.

7. The purchaser shall only have the right to offset the invoice if his counter-claims are established by force of law, are undisputed or have been recognised by us.

§ 6 Data Storage

Information regarding § 33 of the German Federal Law on Data Protection: Customer data shall be stored.

§ 7 Shipping and Transport Damage

1. Products shall be shipped at the customer's risk. When a consignment is dispatched from the warehouse, risk shall be transferred to the customer. Insurance shall only be provided if specifically requested. An insurance premium amounting to 1% of the value of the goods shall then be charged.

2. If the purchaser finds that the packaging has been damaged (transport damage), he shall arrange for the damage to be certified by the transport company when the goods are accepted. Transport damage which is only ascertained after the goods have been unpacked shall be reported in writing to us within three days after receipt of the goods. This written report shall also be received by us within the same period.

§ 8 Warranty and Liability

1. Complaints concerning the condition of the supplied goods and any defects or damage shall only be considered if they are raised in writing with accompanying evidence within eight days of receipt of the goods, or after hidden defects are discovered, at the very latest within six months of receipt of the goods.

2. Our legal warranty shall be limited to repair or replacement of the product at our choice. If we fail to repair the product or deliver a replacement, the purchaser shall be entitled to choose between rescinding the contract or demanding a reasonable reduction in the purchase price.

3. We shall accept no liability for consequential damage.

4. The limitation period for claims and rights arising from defects shall be one year.

5. Liability limitations and exclusions shall not apply in the case of intent or gross negligence.

§ 9 Returns

Goods may only be returned with our approval. The reason for returning a product shall be entered on the return form. A copy of the corresponding invoice shall be enclosed with the returned product. Customised products may not be returned. In the case of goods returned against a credit note, we shall deduct a 10% handling charge. All returns shall be made at no cost to us. Items that have been altered or damaged by the purchaser may not be returned.

§ 10 Reservation of Title

1. The sold goods shall remain our property up until the time of full payment of the claims arising from our contractual relationship with the purchaser. The purchaser may dispose of the purchased goods in the course of normal business. The purchaser shall now assign to us as security the claims arising against third parties from the resale of goods. The purchaser shall be authorised to collect these claims on our behalf until the revocation or cessation of his payments.

2. If third parties, especially bailiffs, seize goods belonging to us, the purchaser shall make reference to our property and shall inform us immediately by means of registered letter or a fax.

3. If the purchaser violates the terms of the contract, especially if he is in arrears, we shall be entitled to take back the goods belonging to us. Exercise of the reservation of title shall not signify withdrawal from the contract.

§ 11 Place of Performance, Place of Jurisdiction, Applicable Law

1. The place of performance for all obligations arising from the contractual relationship shall be Karlsbad.

2. For all disputes arising from the contractual relationship, if the purchaser is a registered trader, a legal entity in public law, or a special fund under public law, legal proceedings shall be instigated at the court that has jurisdiction over our head office. We shall also be entitled to file an action at the headquarters of the purchaser.

3. German law shall apply exclusively to the contract to the exclusion of the UN Convention on the International Sale of Goods.

§ 12 Copyright

We reserve all rights to the ownership and copyright of images and diagrams, in particular photographs of our products, drawings, cost calculations and other documents. This provision applies above all to all written documents that are marked as "Confidential". Customers and/or business partners may use or pass on said images, diagrams and documents only subject to the prior written consent of DIETZ GmbH.

§ 13 Saving Clause

If one of the provisions of this contract is invalid or becomes invalid during the term of the contract, the validity and effect of the other provisions shall not be affected.



DIETZ GmbH Reha-Produkte
Reutäckerstraße 12
76307 Karlsbad
Telefon +49 7248.9186-0
Telefax +49 7248.9186-86

info@dietz-reha.de
www.dietz-reha.de

TOMTAR

Tomtar is a registered trade mark of Dietz GmbH.

Status 11/2018 | V2.0.0